

产品名称:	直流减速电机
型号:	GM50
分类:	梨形直流减速电机
用途及说明:	咖啡机, 通讯仪器, 自动化产品, 感应垃圾筒, 电子锁具, 光学设备, 医疗器械, 办公设备, 家用电器及各种仪器仪表的驱动及控制。
重量:	约85g

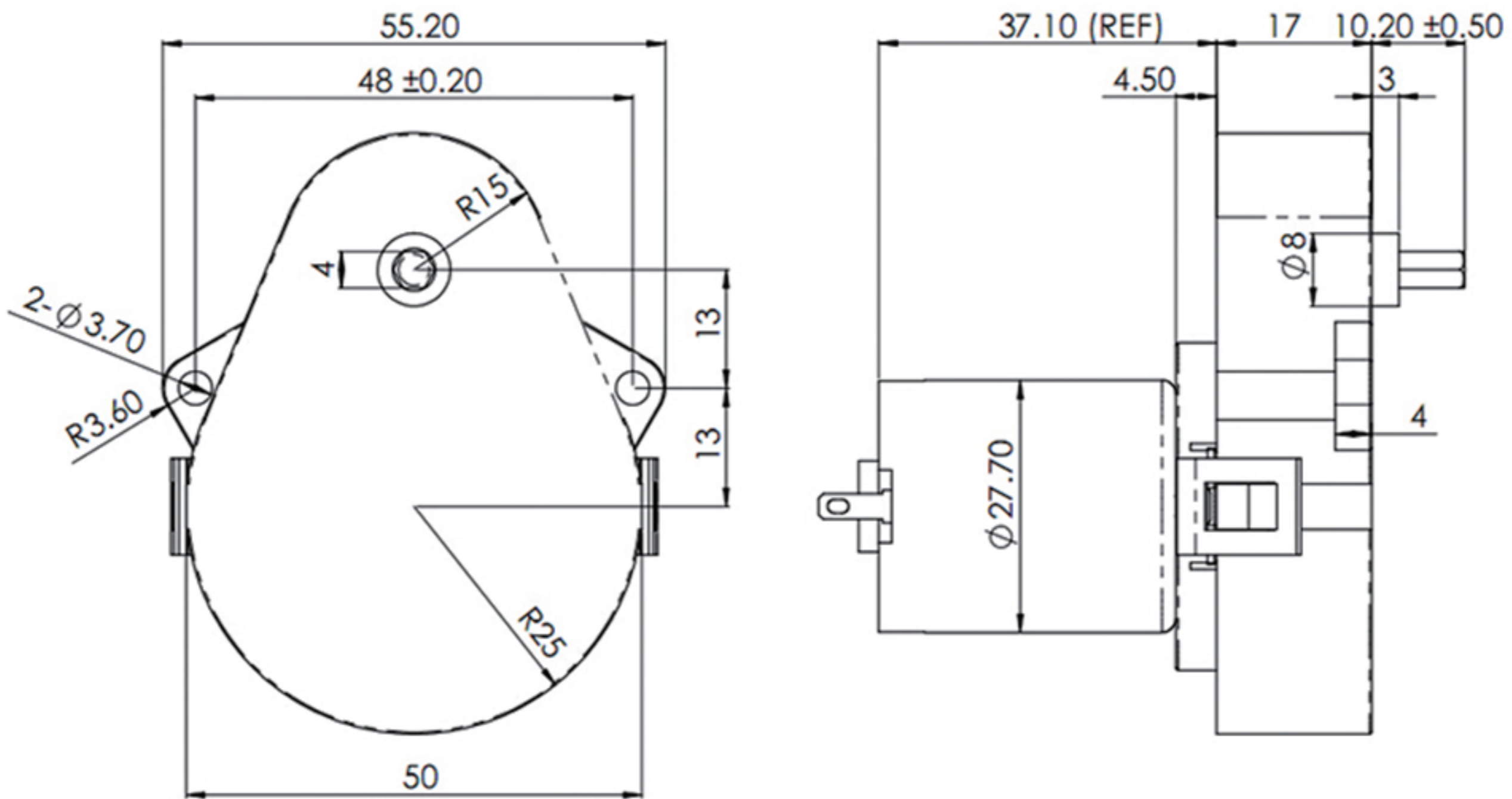

型号 MODEL	电压 VOLTAGE	空载 AT NO LOAD		最大效率点 AT MAXIMUM EFFICIENCY				堵转 AT STALL		
		转速 SPEED	电流 CURRENT	转速 SPEED	电流 CURRENT	转矩 TORQUE		转矩 TORQUE		电流 CURRENT
		VDC	RPM	A	RPM	A	mN.m	kg.cm	mN.m	kg.cm
GM50600-360	24	11.5	0.095	9.4	0.22	1842.4	18.800	10094	103.000	0.78
可配马达类型 Base motor option	RS360,RS365,RF370,RS380,RS385,RS390,RS395,RF500,RF520,RF500									
标准速比 Gear ratio option	a: 6.25,7.5, 8.33, 11.25, 12.5, 14.1, 15, 17.6, 20, 25, 30, 33.3, 37.5, 41.6, 45, 50,56.25, 60, 62.5, 66.6, 75, 83.3, 84.375, 90, 93.75, 100, 112.5, 120, 125, 133.33, 135, 150, 166.6, 168.75, 180, 187.5, 200, 208.3, 225, 240, 250, 266.67, 270, 281.25, 300, 312.5, 333.3, 337.5, 360, 375, 400, 405, 416.6, 421.875, 450, 468.75, 500, 506.25, 540, 562.5, 600, 625, 666.67, 675, 703.125, 750, 833.3, 843.75, 900, 937.5, 1000, 1041.6, 1125, 1250, 1406.25, 1500, 1562.5, 1666.6, 1875, 2083.3, 2343.75, 2500, 3125) b:(500, 666.67, 694.4, 833.333, 925.925, 1111.1, 1125, 1234.57, 1388.9, 1500, 1851.85, 2000, 2083.3, 2250, 2314.8, 2500, 2666.67, 2777.78, 3000, 3086.4, 3125, 3333.3, 3703.7, 3750, 4000, 4166.67, 4444.4, 4500, 4938.27, 5000, 5208.3, 5555.556, 6000, 6250, 6666.67, 6750, 6944.4, 7407.4, 7500, 8000, 8333.3, 9000, 9259.26, 10000, 10125, 10416.67, 10666.67, 11111.1, 11250, 12000, 12345.68, 12500, 13333.3, 13500, 13888.89, 15000, 16000, 16666.67, 16875, 17361.1, 17777.78, 18000, 18518.5, 18750, 20000, 20250, 20833.3, 22500, 23148.15, 24000, 25000, 26666.67, 27000, 27777.78, 28125, 30000, 30864.2, 33333.3, 33750, 34722.2, 36000, 37500, 40000, 40500, 44444.4, 45000, 46296.3, 46875, 50000, 54000, 56250, 57870.37, 60000, 62500, 66666.67, 67500, 75000, 77160.5, 83333.3, 90000, 93750, 100000, 111111.1, 112500, 125000, 150000, 156250, 166666.67, 187500, 208333.3, 250000, 277777.78, 312500, 416666.67, 520833.3, 694444.4)									
备注 Note	性能参数及输出轴可以根据客户要求更改。 The specifications and output shaft can be changed as customer's request.									
包装信息 Packing detail	纸箱, 尺寸: 38X35.5X34CM; 100台/箱; 毛重: 11Kg. Carton, Size: 38X35.5X34CM; 100pcs/carton; G.W: 11Kg.									



转向: CCW

P <sub>0</sub>	EF	I	N
4	100	900	13
2	50	450	7
[W]	[%]	[mA]	r/min

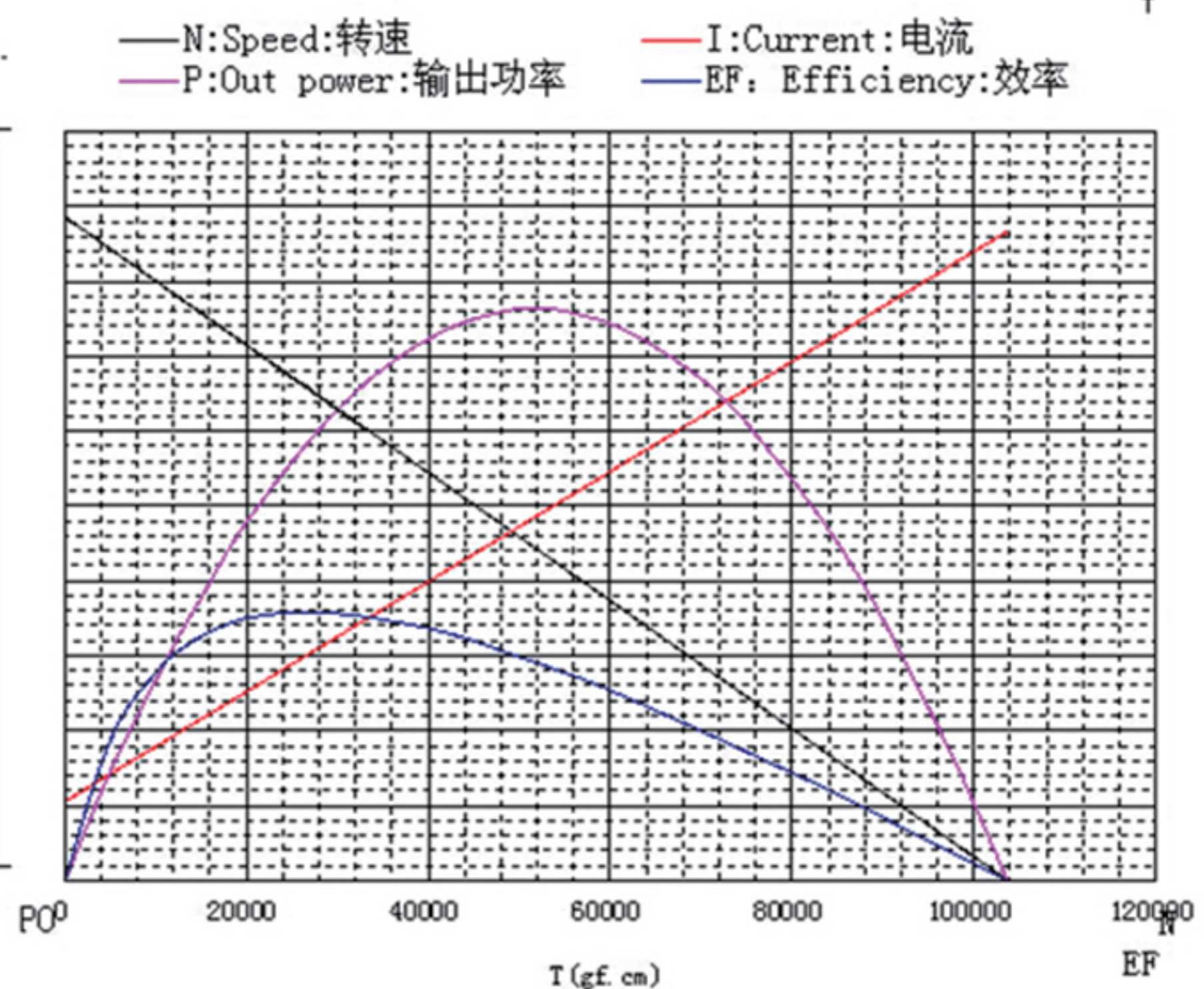

宁波市海曙立诺电器配件有限公司

网址: [www.linomotor.com](http://www.linomotor.com)

邮箱: [sales@linomotor.com](mailto:sales@linomotor.com)